

ASHTON  
CHULA - SILOM





ASHTON



## PROJECT DETAIL

|                         |                              |
|-------------------------|------------------------------|
| TOWER                   | 56 FLOORS                    |
| TOTAL UNITS             | 1182 UNITS                   |
| TYPES OF UNITS          | STUDIO, 1 BEDROOM, 2 BEDROOM |
| No. OF PARKING FACILITY | 560 LOTS                     |
|                         | SWIMMING POOL                |
|                         | KID'S POOL                   |
|                         | JACUZZI                      |
|                         | FITNESS                      |
|                         | PANORAMIC LOUNGE             |
|                         | LIBRARY                      |
|                         | SOCIAL CLUB                  |

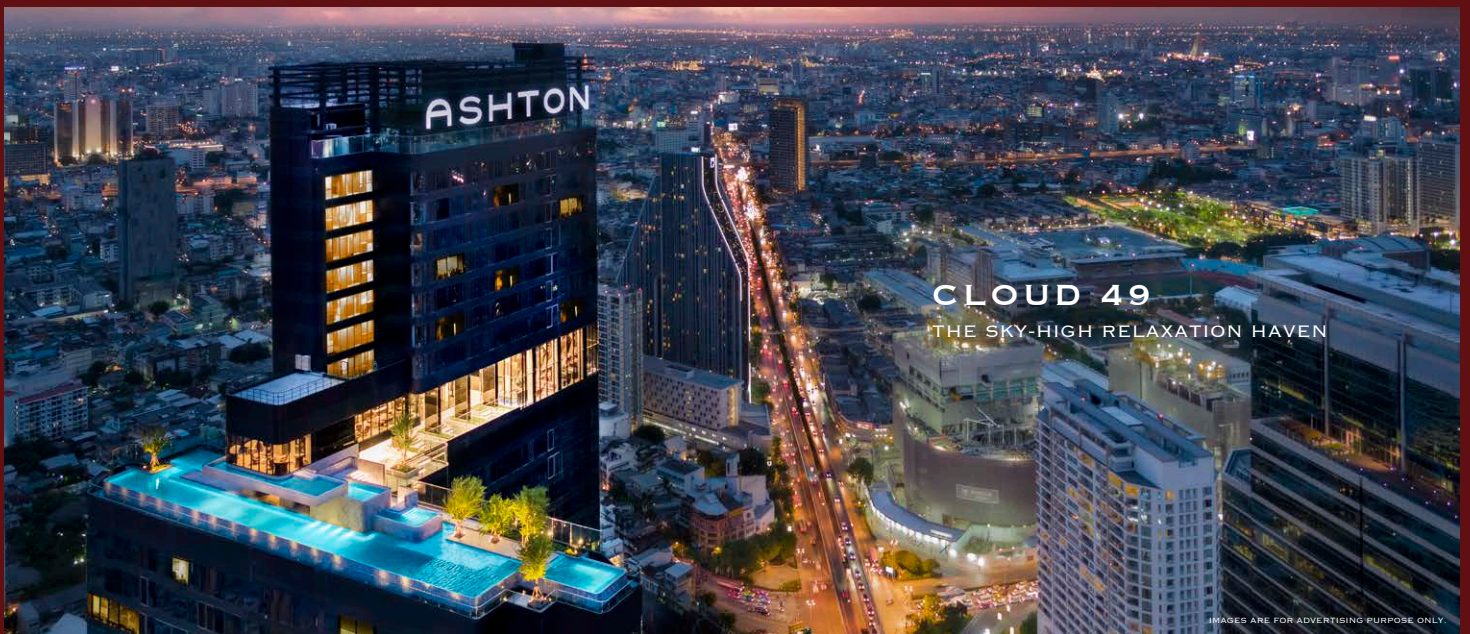

# FACILITY



GROUND FLOOR

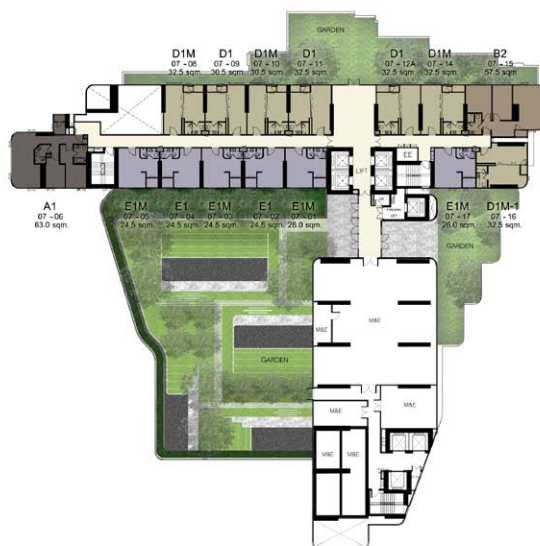

7<sup>TH</sup> FLOOR



49<sup>TH</sup> FLOOR



The developer reserves the right to change without prior notice. The identifying areas are approximately.  
Contents and images are for advertising purpose only. The shown layout is simulated utilize function only.

# FLOOR PLAN

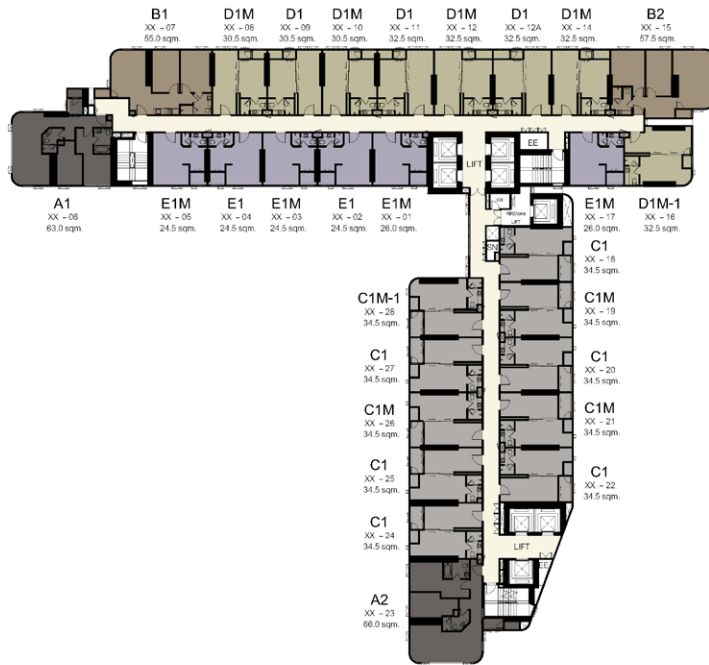

30<sup>TH</sup> FLOOR

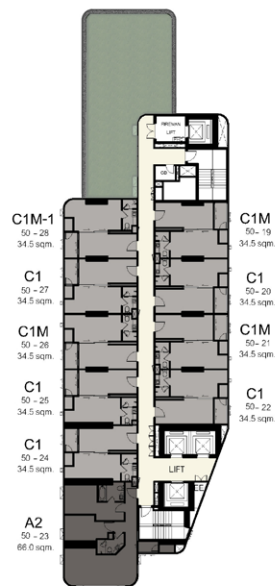

50<sup>TH</sup> - 56<sup>TH</sup> FLOOR



The developer reserves the right to change without prior notice. The identifying areas are approximately.  
Contents and images are for advertising purpose only. The shown layout are simulated utilize function only.



# UNIT PLAN

E1M  
24.5-26.0 SQ.M.



D1M  
30.5 - 32.5 SQ.M.



C1  
34.5 SQ.M.



## UNIT PLAN

B2  
57.5 SQ.M.



A2  
66.0 SQ.M.





180 M.\* TO MRT SAMYAN  
550 M.\* TO BTS SALADAENG



ASHTON CHULA-SILOM CONDOMINIUM PROJECT. PROJECT OWNER: ANANDA MF ASIA SAMYAN CO., LTD. REGISTERED CAPITAL: 1,000,000,000 BAHT (ONE THOUSAND MILLION BAHT – FULLY PAID). OFFICE IS LOCATED AT 99/1 Moo 14, Soi Mooban Windmill, Bangna-Trad (KM.10.5) Road, Bang Phli Yai Sub-District, Bang Phli District, Samut Prakan Province. MANAGING DIRECTOR: CHANOND RUANGKRITYA. PROJECT TYPE: THE 56-STORY CONDOMINIUM WITH 1,182 (FOR RESIDENTIAL 1180 UNITS AND COMMERCIAL 2 UNITS. COMMON PROPERTIES: SWIMMING POOL, MULTI-PURPOSE ROOM, FITNESS ROOM. PROJECT LOCATION: RAMA 4 ROAD, SRIPRAYA SUB-DISTRICT, BANGRAK DISTRICT, BANGKOK. PROJECT IS LOCATED ON TITLE DEEDS No. 53039, 53040, 53041, 53042 SRIPRAYA SUB-DISTRICT, BANGRAK DISTRICT, BANGKOK. THE APPROXIMATELY LAND SIZE IS 4-0-88.3 RAI. THE PROJECT HAS OBLIGATIONS TO BANGKOK BANK PLC. THE PROJECT HAS ALREADY BEEN APPROVED THE ENVIRONMENTAL IMPACT ASSESSMENT (EIA). CONSTRUCTION COMMENCEMENT IS EXPECTED BY JULY 2015 AND COMPLETION IS EXPECTED BY SEPTEMBER 2018. ONCE THE CONSTRUCTION IS COMPLETED, THE PROJECT WILL THEN BE REGISTERED AS A RESIDENTIAL CONDOMINIUM BUILDING. CO-OWNERS OF THE BUILDING ARE BY LAW REQUIRED TO BE RESPONSIBLE FOR ANY COMMON FEES AND TAX FEES TO BE INCURRED.